

# DC BLOCK

7/16 DIN, 800 MHz - 2.8 GHz, Inner Only

## SPECIFICATIONS:

Models: 8550

**RoHS**  
Compliant

### Electrical:

Frequency Range \_\_\_\_\_ 800 MHz - 2.8 GHz  
VSWR \_\_\_\_\_ 1.20:1 Max.  
Impedance \_\_\_\_\_ 50 Ohms  
Insertion Loss \_\_\_\_\_ 0.2 dB Max.  
Voltage Rating \_\_\_\_\_ 3000 Volts Max.  
RF Power, CW \_\_\_\_\_ 500 Watts  
RF Power, Peak \_\_\_\_\_ 1000 Watts  
Isolation \_\_\_\_\_ 64dB Typical @ 1 KHz  
Operating Temp. Range \_\_\_\_\_ -65°C to +125°C

### Mechanical:

7/16 - DIN Connectors \_\_\_\_\_ Silver Plated Brass  
IAW DIN 47 223  
Conductors \_\_\_\_\_ Silver Plated Beryllium Copper



Model Number: **8550**

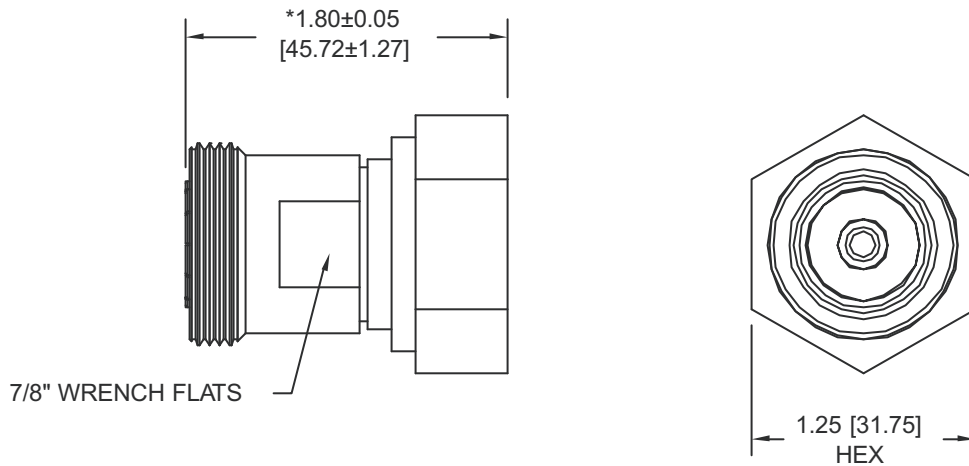

\*Dimension Occurs with Nut Biased Forward

Note: Dimensions in Brackets are Expressed in Millimeters and are for Reference Only.

8550: REV-



Aeroflex / Inmet, Inc. • 300 Dino Drive, Ann Arbor, MI 48103 • U.S.A.  
888-244-6638 or 734-426-5553 • FAX: 734-426-5557  
www.aeroflex.com/inmet • inmet@aeroflex.com